

GBJ610 Base

Features

- Reinforced polyamide body with excellent durability and resistance against chemicals, weather and wear
- For $\phi 50.8$ pipe
- Can be used for $\phi 25$, $\phi 32$, $\phi 38$ pipe with spacer (sold separately)
- Suitable for medical equipment, etc.

Notes

- When using a spacer, fix it to the bottom of the pipe with fixing plate and screw
- Screw not included

Sold Separately

- Spacer **GHOS**
- Fixing plate **GHOS-Z**
- Caster **GCTW38**

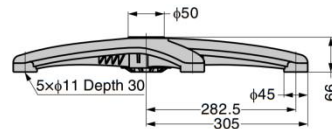
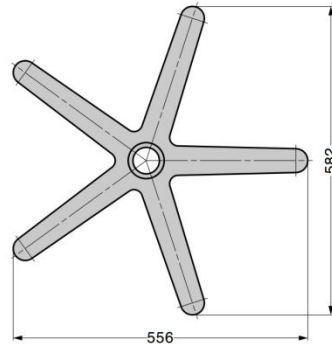

GBJ610

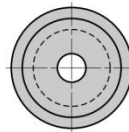

Fixing plate

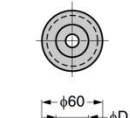

Spacer



Spacer (Sold Separately)



Caster (Sold Separately)

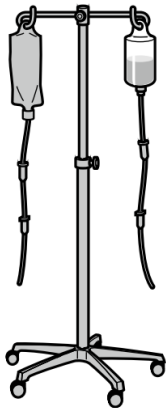

Installation

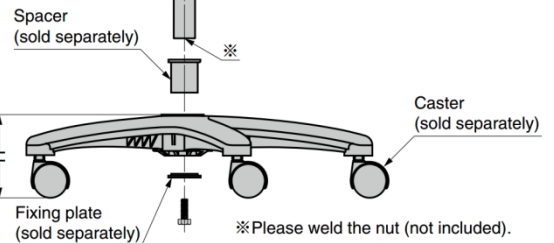

Body

Part No.	Material	Finish
GBJ610	Reinforced Polyamide	Dark Grey

Spacer (Sold Separately)

Part No.	Material	Finish	D
GHOS-25	PA	Black	25
GHOS-32			32
GHOS-38			38

Fixing Plate (Sold Separately)

Part No.	Material	Finish
GHOS-Z	Stainless Steel 304	Barrel Polished

Caster (Sold Separately)

Part No.	Material	Finish	Wheel Diameter
GCTW38	PA / Urethane	Black	50